

S:\TRAFFIC\TranMan\00TM Projects\RS15000\RS15015 - Romney Avenue Area Parking Review\006 Drawings\Working\RS 15015 - Romney Avenue - Proposed New Arrangement.dwg - Plotted by jbsk6 on Dec 03, 2015 - 1:06pm

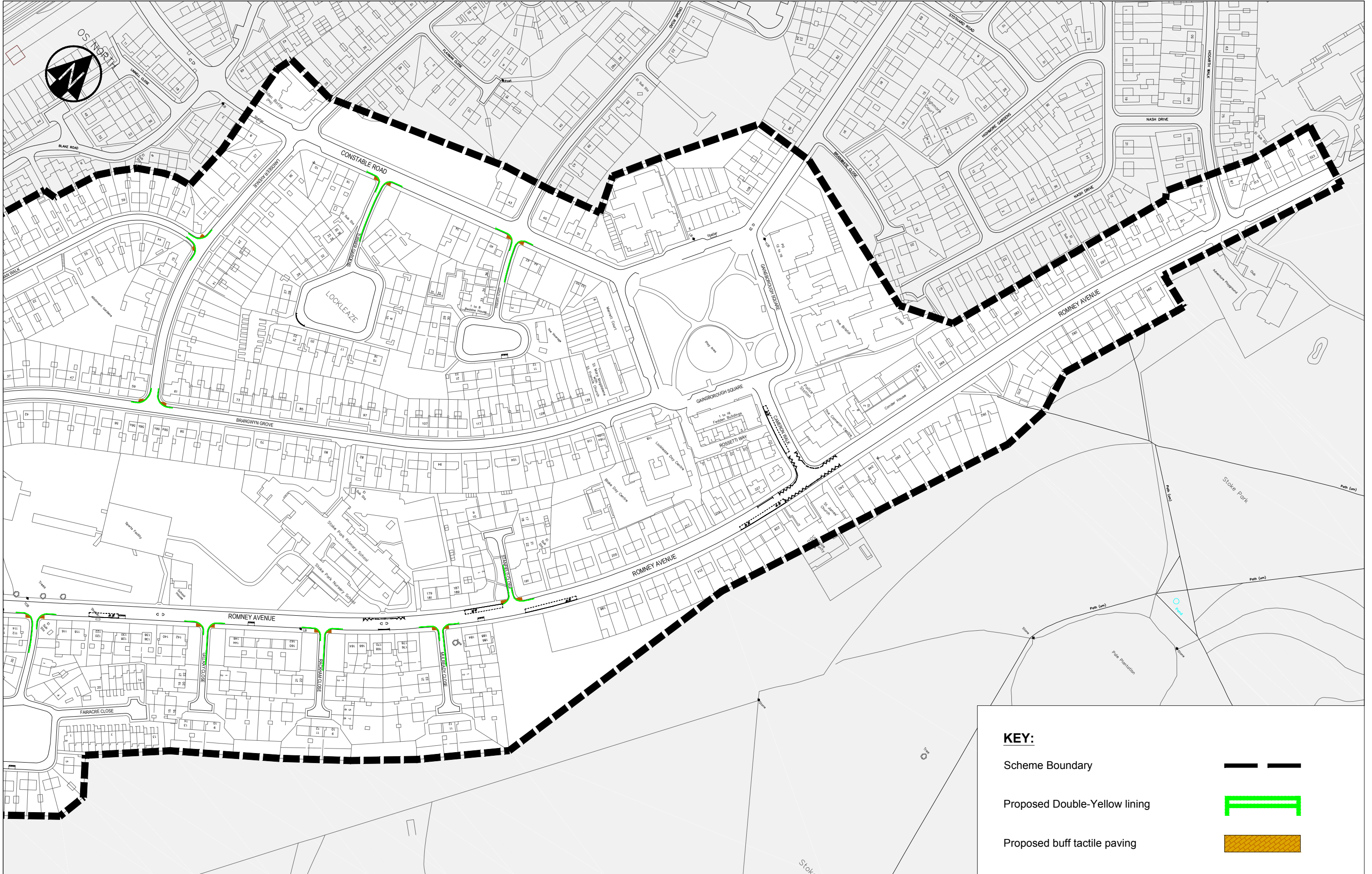

**KEY:**

- Scheme Boundary
- Proposed Double-Yellow lining
- Proposed buff tactile paving

**Place**  
 Peter Mann (Service Director)  
 Brunel House  
 St. Georges Road  
 Bristol  
 BS1 5UY



HIGHWAY SERVICES  
**RS 15015 - Romney Avenue Area Parking Review**  
 BS7, Lockleaze, Bristol  
 Proposed Layout, part 2of2

This map is reproduced from Ordnance Survey material with the permission of Ordnance Survey on behalf of the Controller of Her Majesty's Stationery Office © Crown copyright. Unauthorised reproduction infringes Crown copyright and may lead to prosecution or civil proceedings.  
 Bristol City Council. 100023406. 2014

Dwg <b>RS 15015 - Lay2</b>	Rev 1
Scale NTS @ A3	
Date 27 Nov 2015	Init D.K.